

Replacement Parts List

P/N: 068-521-060-009 (903165) Sensor, Length/Angle 521/09

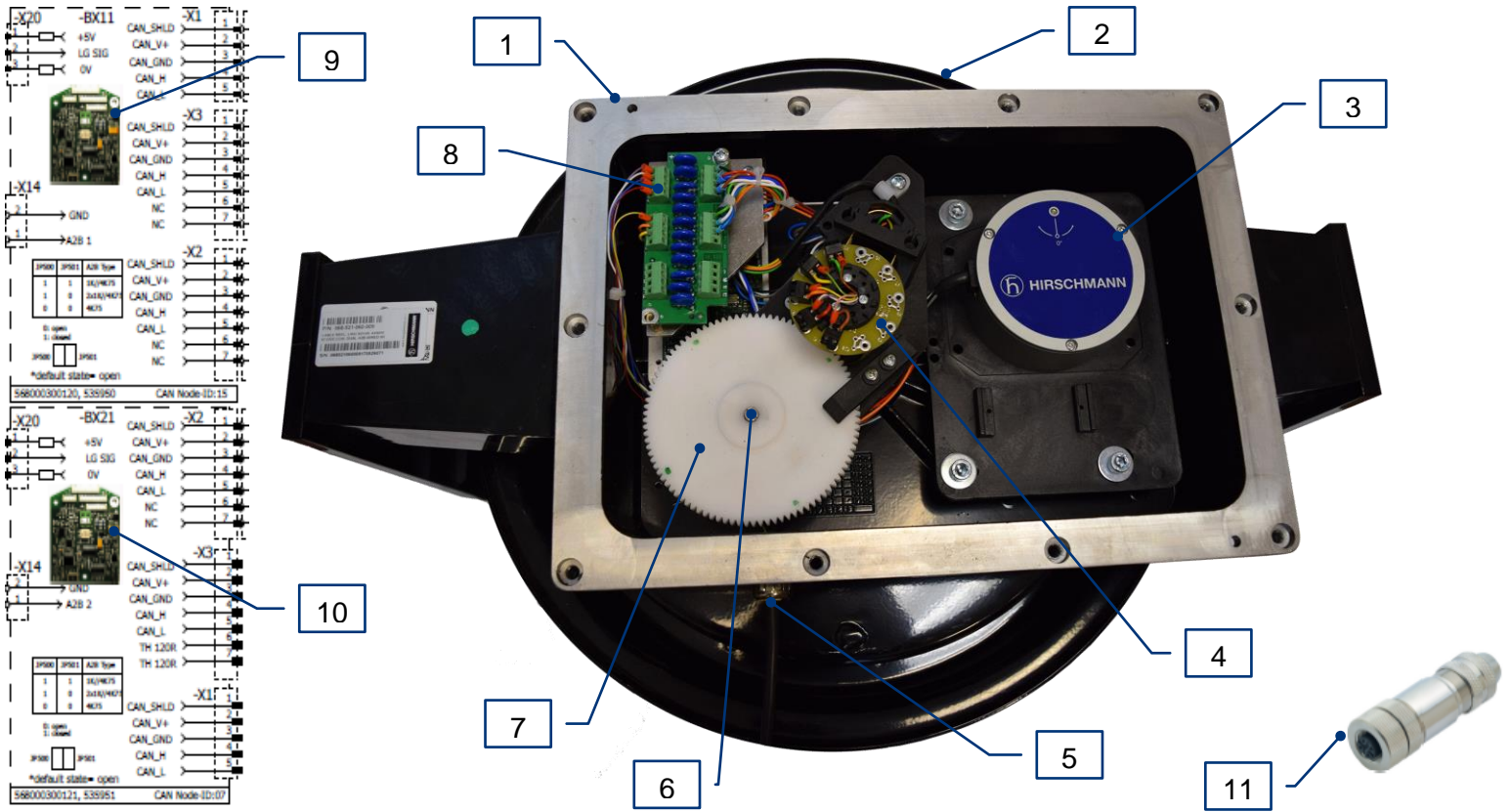

#	Part #	SAP #	Qty	Description
1	068-521-100-001	536768	1	Cable Reel Housing, w/ Spring,Drum,Cover,Mounting Arms
*1.1	068-000-100-196	527470	1	Cable Reel Accy, Cover with Screws
*1.2	068-000-050-203	527485	1	Cable Reel Accy, Drum Only
*1.3	068-000-050-197	527473	1	Cable reel Mounting Arm Bracket (Left)
*1.4	068-000-050-198	527474	1	Cable Reel Mounting Arm Bracket (Right)
*1.5	000-205-031-230	n/a	4	Screw, 12mmx30mm Hex Head (Mounting Bracket Arm)
*1.6	000-208-020-012	n/a	4	Washer, Lock, 12mm Tooth (Mounting Bracket Arm)
2	000-673-060-014	311036	197'	Cable, Length 6 Core (Sold by the foot)
3	064-360-061-551	606700	1	Sensor, Angle WGC360/1551
4	068-000-110-163	537443	1	Slipring, 5 Conductor
5		537155	1	Cable Reel Accy, Cable Assembly Connection
6		532082	1	Sensor, Length Pot 203 OVW 300MM 067-000-100-203
7	067-000-050-126	n/a	1	Gear Wheel, 96 Tooth
8	068-000-300-095	536933	1	Board, Terminal Connection
9		535950	1	Board, Length & A2b CAN 068-000-300-120
10		535951	1	Board, LS-0121, 1XLS a2B & 2XCAN 068-000-300-121
11		531737	1	Connector, M12,5POLE, SOC, Straight (Length Cable)